

**INDUSTRIAL DOOR SYSTEMS**



# ThermAdor Industrial

Insulated Sectional Door





# Kingspan Door Components

Kingspan Door Components offer a high quality, comprehensive range of insulated panels and accessories for sectional doors, and we are focused on providing innovative product solutions with value added benefit for all our customers.

Whilst being a market leader, we benefit from the resource support provided by a powerful group within the industry. Kingspan is proud of its reputation for innovative design, exceptional quality and technical expertise.



Kingspan Door Components has its factory base at Leuzen-Hainaut in Belgium. From here we operate an advanced production complex servicing all European and worldwide export markets. The Kingspan Door Components range of products, for use in industrial and residential applications, is manufactured exclusively in Ireland by our partner TiltAdor Ltd.

We hope you will choose the ThermAdor range for your next project.

In partnership



Peter Santo  
Managing Director

# TiltAdor Garage and Industrial Door Manufacturer



Established in 1984, TiltAdor is a leading manufacturer of a range of doors for the residential and industrial market and Ireland's only manufacturer of industrial sectional doors.

To meet the increasing demand for energy efficiency, we have teamed up with Kingspan, widely regarded as a leading edge provider of insulation and building materials for the construction industry. Together we are delighted to offer the ThermAdor range of insulated sectional doors which are available through our national network of authorised distributors.

Doors are our business and both quality and safety are at the forefront of everything we do. Our strategic partnership with Kingspan means that, when you choose one of our doors, you are selecting the best in quality, design, features, safety and service. As part of our commitment to you, we run training seminars regularly and we extend a welcome to you to visit us at our factory showroom in Newtownards, Co Down.

We look forward to doing business with you in the future.

In partnership



Emmet McGrogan  
Managing Director



Emmet McGrogan, TiltAdor  
with Peter Santo, Kingspan  
Door Components

# Contents

Introduction	2
ThermAdor Industrial	4
Thermal Performance	8
Colour Range	10
Glazing Solutions	12
Track Systems and Accessories	14

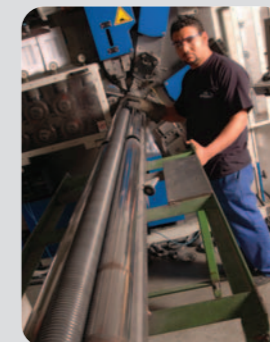



# ThermAdor Industrial



When you're looking for excellent thermal efficiency, superior quality, maximum security and long-term durability, look no further than the ThermAdor range of insulated sectional doors.



ThermAdor Industrial

All of our ThermAdor Industrial insulated door panels are manufactured and finished to the highest quality standards in order to achieve maximum durability.



## The thermally efficient, ThermAdor Industrial 40

Our standard 40mm insulated door panels offer excellent energy efficiency with a U value of 0.51 W/m<sup>2</sup>K. ThermAdor Industrial 40 achieves an installed / complete door U-value of an impressive 1.2 W/m<sup>2</sup>K.

ThermAdor Industrial not only looks good, it provides outstanding performance in all weather conditions. The door consists of 40mm thick interlocking panels, made of premium quality galvanised steel, filled with polyisocyanurate (PIR) insulation. The strength of the panel, along with full perimeter and joint seals, gives exceptional protection against wind and rain ingress.

Every door is made-to-measure and, with two panel designs and an extensive range of colours and finishes, ThermAdor Industrial will enhance the appearance of any building. If quality, style and energy efficiency are important to you, then make ThermAdor Industrial your first choice.

*ThermAdor Industrial is suitable for openings of up to 36m<sup>2</sup>.*

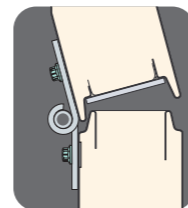

Traditional joint detail

Linear Rib Profile

Micro Rib Profile

40mm

## For the ultimate thermal performance, ThermAdor Industrial 80

Our 80mm insulated door panels offer superior energy efficiency and low carbon emissions which deliver a significantly reduced panel U value of 0.24 W/m<sup>2</sup>K. ThermAdor Industrial 80 achieves an installed / complete door U-value of an impressive 0.54 W/m<sup>2</sup>K.

The door can withstand internal / external temperature differences of up to 40°C and help to provide a controlled sterile environment. This makes ThermAdor Industrial 80 suitable for use within temperature controlled and hygiene safe environments, such as food processing areas, cold and chill stores and clean rooms.

Kingspan 80mm panel benefits:

- Superior U-value performance which gives cost savings / environmental benefits
- Ideally suited for coldstore / chillstore applications
- Can withstand temperature differences of up to 40°C
- Option of White Food Safe laminate on special request
- Available in White RAL 9010 Stucco Embossed Linear Rib. Other colours and finishes on request subject to minimum order quantity.

Linear Rib Profile

80mm



# ThermAdor Industrial

## The Insulated Panel

- Kingspan **ECOsafe** insulated panels use an environmentally sustainable **FIREsafe** PIR insulation core.
- Kingspan **ECOsafe** insulated panels are the result of extensive research and development work to provide an optimised and sustainable solution for our customers.
- Kingspan **ECOsafe** insulated panels have a low GWP (Global Warming Potential <5).

The Kingspan panel consists of 40mm or 80mm thick HFC, CFC and HCFC free polyisocyanurate (PIR) expanded foam insulation, sandwiched between two sheets of high strength galvanised steel. The closed cell PIR foam matrix auto adhesively bonds to the impermeable outer skins, preventing water absorption and providing long term thermal performance and reliability. The panel outer skin consists of 0.45mm continuous hot dip, zinc-coated structural steel (95% zinc, 5% aluminium).

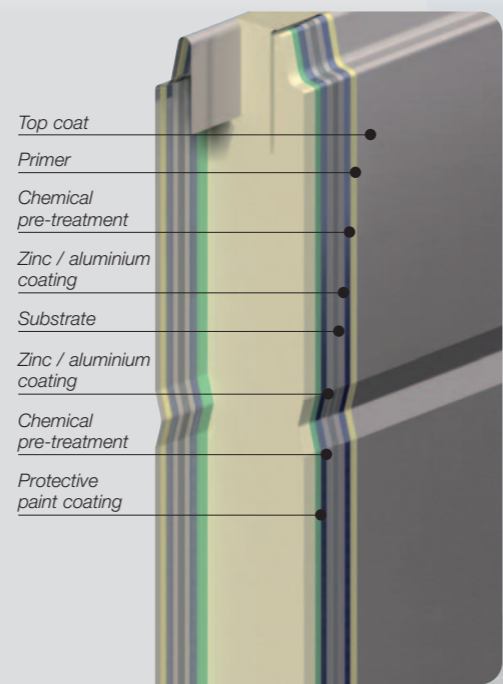

## Innovation



The Kingspan Chemical Team and laboratory on site

From concept and design to manufacture, Kingspan Door Components are committed to advancing technology. ThermAdor Industrial's polyisocyanurate foam core, which is unique to Kingspan, is self-extinguishing and more difficult to ignite than other types of insulated panel. The chemical formulation is the same as Kingspan's Roof and Wall panel which meets LPS 1181 and FM 4880 insurance approval standards and is fully certified to EN 13501 Fire Classification of Construction Products and Building Elements.



## Weatherproof Design

In addition to its superior thermal performance, ThermAdor Industrial provides outstanding weatherproofing.

### Wind Resistance EN 12424 – Test Result Class 5 (>1000Pa)

Tested door withstood air pressure up to 1520Pa, equivalent to 180km/hr winds. Class 5 is the maximum rating achievable and is described as 'exceptional' performance.

### Resistance to Water Penetration EN 12425 – Test Result Class 3 (>50Pa)

Tested door withstood leakage up to 130Pa. Class 3 is the maximum rating achievable for resistance to water penetration.

### Air Permeability EN 12426 – Test Result Class 3 (<6m³/m².hr)

Tested door leakage at 50Pa positive pressure = 4.3m³/m².hr. The maximum air permeability allowable, in terms of building regulations, is 10m³/m².hr. ThermAdor Industrial's reduced air permeability (i.e. a high level of air tightness) serves to further reduce carbon emissions and is a cost-effective means of improving the energy efficiency of a building.



## Designed with Safety in Mind

ThermAdor Industrial has been tested to the highest safety standards and incorporates the most advanced safety features available.

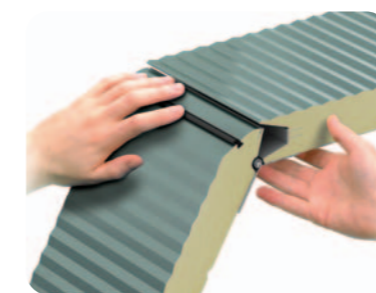

### Fully Compliant with Standards

**CE** ThermAdor Industrial is CE marked and meets the requirements for conformity with the Construction Products Directive.

### Cable Break and Spring Break Devices

In the event of a cable snapping or a spring breaking, the safety devices will activate and prevent the door from falling.

### Protection Against Finger Trapping

Doors under 2500mm high are supplied with 'FingerSafe' anti-pinch panel in compliance with European Standard EN 12604.

## Independently Tested

ThermAdor Industrial has undergone rigorous independent testing by SP Swedish National Testing & Research Institute so you can be confident that it fully complies with current legislation. But don't just take our word for it... ask for a copy of our test report. We're proud of our results!



It's our commitment to high quality that make us first choice with architects, contractors and developers. For more information on the regulations in relation to industrial doors, ask about our CPD seminars which are approved by The Royal Institute of the Architects of Ireland (RIAI).



# Thermal Performance



The thermal performance of the building envelope can make a significant contribution to reducing the overall building energy usage. Our insulated door panels form an integral part of the buildings in which they are used and serve to help lower the operational energy demand†.



Thermal Performance



## Maximum Thermal Performance Guaranteed

Vehicle access doors and other large doors form an integral part of industrial buildings and, in many situations, contribute to a significant percentage of the overall building elements. Door component thermal performance will affect the overall energy performance of a building and door component ratings will contribute to the overall Building Emissions Rate (BER).

Current Building Regulations\* for new buildings stipulate a maximum area weighted U value of 1.5 W/m²K for vehicle access doors / large doors on non-dwellings. Independent test results show that ThermAdor Industrial surpasses this requirement.

### Thermal performance of installed doors compared to regulations

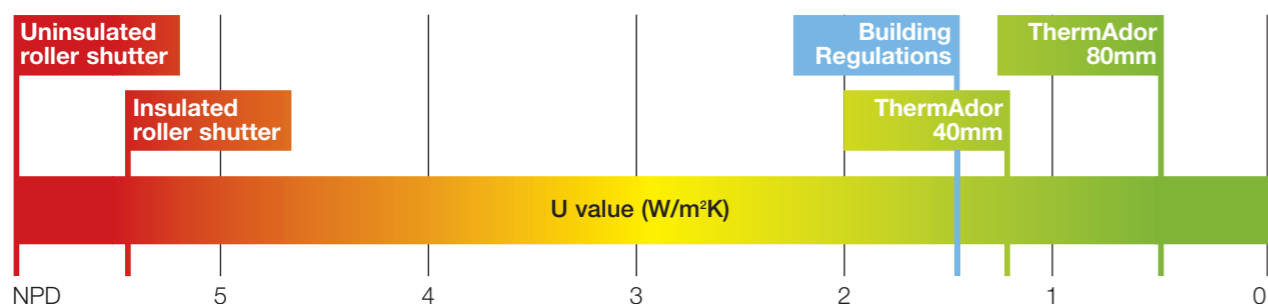

NPD = no performance determined.  
 \*Part L2A (England & Wales), Part F2 (Northern Ireland), Part L (Republic of Ireland), Conservation of Fuel & Power, non-dwellings.  
 †82-86% of a building's life cycle energy is used in the operational phase of running a building with 40-60% of same being for heating purposes.

## Comparison of Thermal Performance with other Door Types

We take thermal performance seriously. Unfortunately, there is sometimes a mistaken belief that other common door types have an equivalent thermal performance to ThermAdor Industrial. In the door industry, U values, testing and the building regulations in relation to installed doors are widely misunderstood and are therefore reported inaccurately. The U value of a roller lath or an insulated panel is often interpreted as being the U value of an 'installed door', but this is incorrect and misrepresents the door's thermal characteristics. So, if in doubt, ask for proof in the form of an independent test report.

	Traditional Industrial Insulated Roller Shutter	ThermAdor Industrial Insulated Sectional Door
<b>Insulation</b>	✗ Average 25mm	✓ Choice of 40mm or 80mm
<b>Thermal Bridging</b>	✗ Areas indicated where door is not insulated and is subject to cold bridging. This can account for up to 30% of the door area	✓ Panel design and seals between panel joints eliminate cold bridging
<b>Weatherproofing</b>	✗ Brush strip	✓ Side, top and bottom weatherseals to minimise heat loss
<b>Performance</b>	✗ Installed Door U values range from 5.0 to 5.8 W/m²K ✗ Curtain lath U values range from 1.3 to 5.3 W/m²K	✓ Installed Door U values range from 0.54 to 1.3 W/m²K ✓ Panel U value 0.24 or 0.51 W/m²K

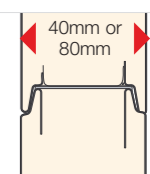
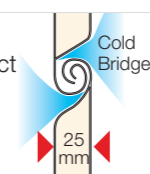



# Colour Range



Our industrial door panel range is available in a wide choice of industry inspired colours, providing enhanced UV protection, colour fastness and superior abrasion and scratch resistance.



Colour Range

## Finishes

ThermAdor Industrial 40 is available in Linear Rib or Micro Rib in a range of colours and choice of finish. ThermAdor Industrial 80 is available in White RAL 9010 Stucco Embossed Linear Rib. Other colours / finishes on request.

### Linear Rib profile

A 120mm pattern, may be specified with a Stucco stippled embossment or as Kingspan XL Forté™ leathergrain.

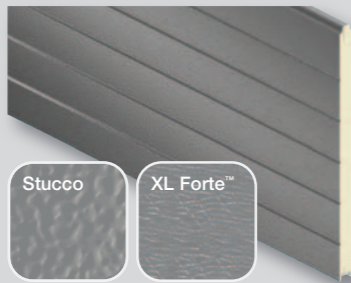

### Micro Rib profile

This is a contemporary finish which perfectly complements modern architecture.

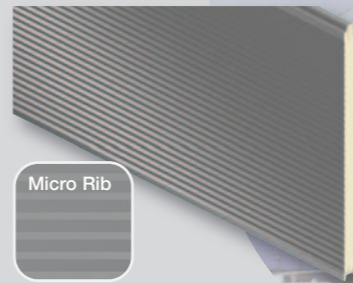

The inside of the door is White RAL 9010, 25 micron, stucco embossed, polyester coated, 100mm Linear Rib design.

## Kingspan XL Forté™ (Plastisol)

Kingspan XL Forté™, with its 200 micron leathergrain textured surface, matches plastisol coated steel currently available in the market. Manufactured to the highest standards, the multi-layered exterior thermoplastic finish of Kingspan XL Forté™ guarantees outstanding performance, durability and colourfastness.

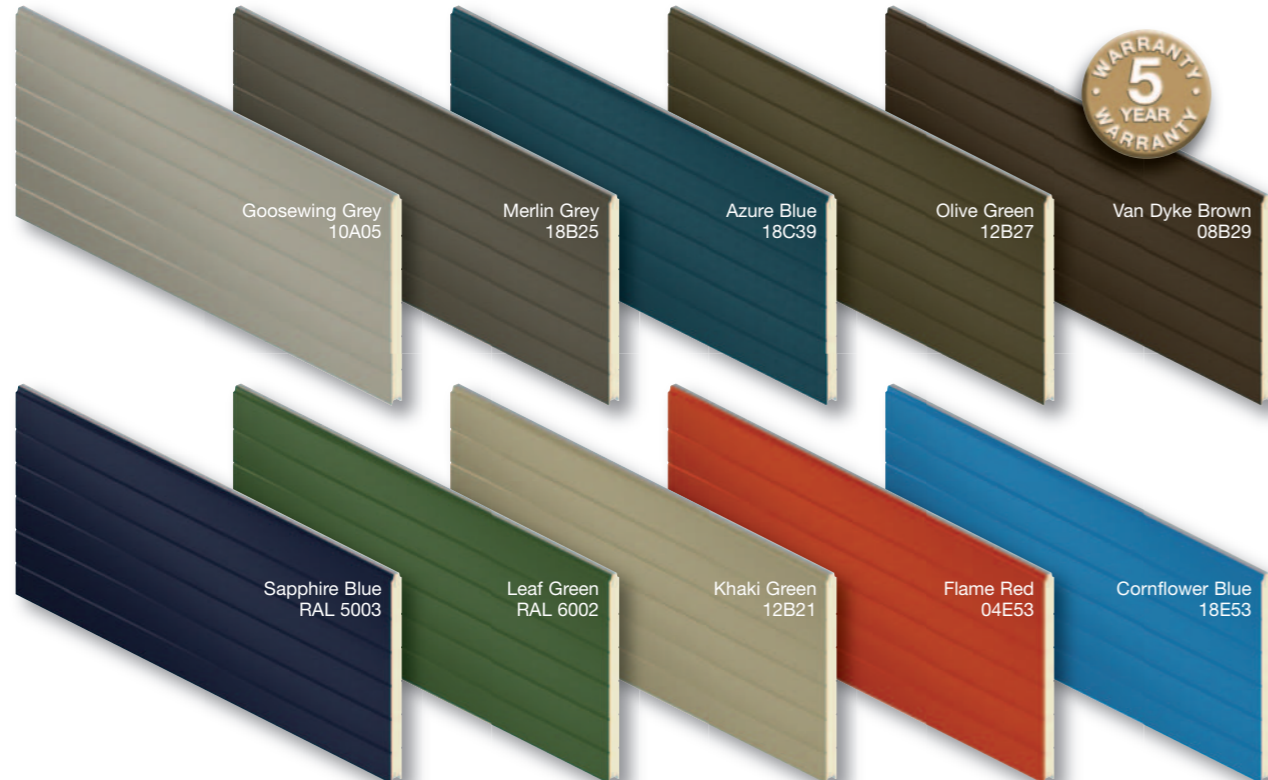

## Stucco Embossed (Polyester Coated)

The Kingspan pre-painted 25 micron polyester colour coated system used on the Stucco range offers excellent resistance to corrosion, chemical attack, ultra-violet light and abrasion.



## Micro Rib (Polyurethane Based Coating)

Our Micro Rib Plus range has a 25 micron polyurethane base which offers three times the protection of the standard polyester finish and delivers superior abrasion resistance. This high performance finish matches the Kingspan Architectural Wall Panel.

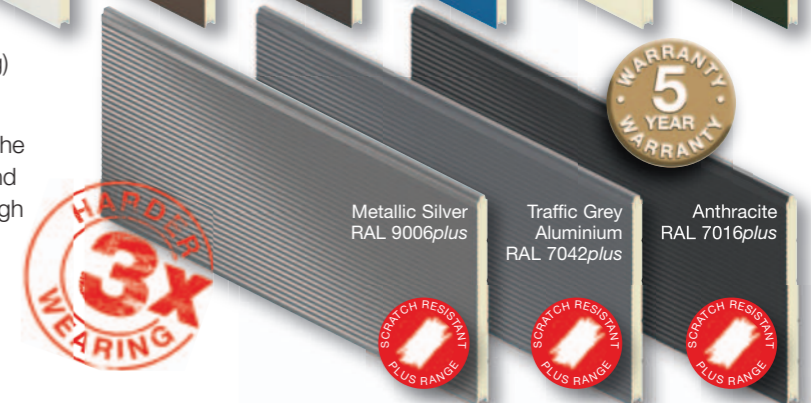



## Glazing solutions...

...let the light shine through.

We have a range of high quality glazing solutions designed to enhance your industrial sectional door. Available as fully assembled door panels or as a choice of shaped windows to incorporate into your door, they offer a complete solution to your glazed panel needs.



ThermAdor Industrial sectional doors are individually made-to-measure. As part of our service and commitment to you, our team will liaise with you to discuss your requirements and review the range of options available to meet your needs.

### Kingspan Vista Panel

Kingspan Vista is a range of aesthetically pleasing, high quality, aluminium profiles designed to enhance your door. Vista Panels can be placed at the top of the door, at the base of the door, or as intermediate panels... the decision is yours!

- Integrates seamlessly with the Kingspan insulated door panel range.
- Available with single or double glazing.
- Pre-finished anodised or painted in your chosen RAL colour.



### Kingspan Vision Windows

Our double glazed and fully sealed range of Vision Windows are a popular choice for both ThermAdor Industrial 40 and ThermAdor Industrial 80. They offer flexibility in terms of design and you choose the number of windows and where you want them.





# Track Systems and Accessories

ThermAdor Industrial is available with a choice of track arrangement. We will be pleased to email full technical specifications on request.

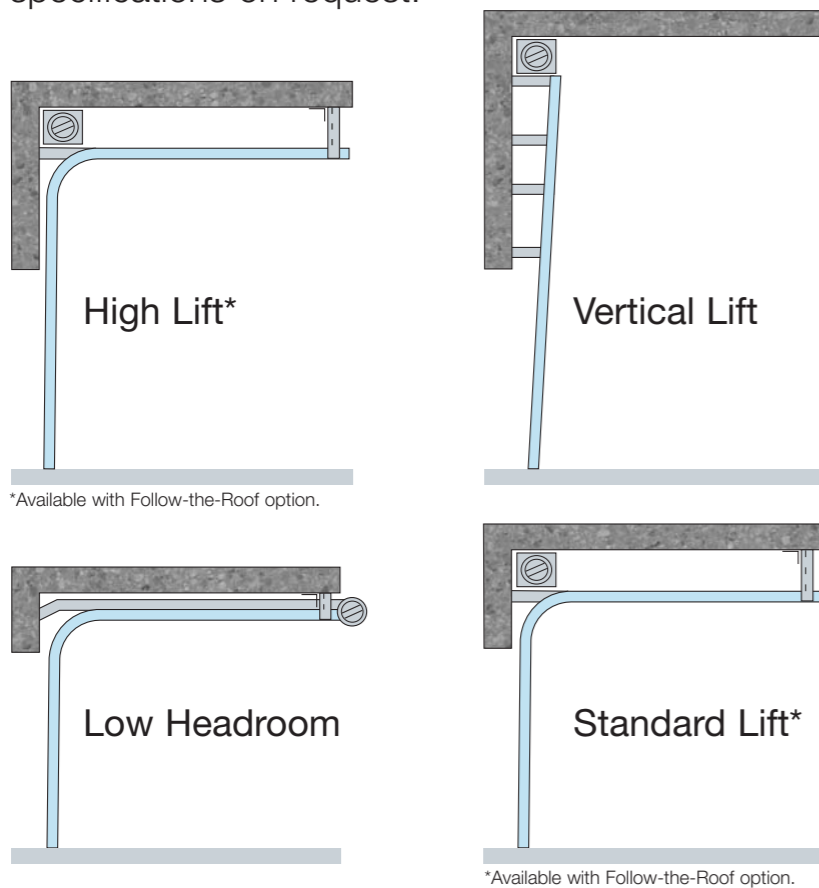

Track Systems and Accessories

## Technical Service



Our specialists are pleased to answer technical queries regarding the use of our products from the specification stage right through to installation. Our customer services department provides a professional, friendly and efficient service. We're always happy to help.

## Industrial Accessories

To complement our industrial sectional door range, we offer a high quality, comprehensive range of accessories and components. Depending on your requirements, ThermAdor Industrial can be operated manually or with an automatic opener. We offer a range of motors for automatic operation, all of which are CE marked and have safety features as standard. Manual doors may be push-up (up to 3000mm x 3000mm) or operated using a chain mechanism (over 3000mm x 3000mm). An optional handle footplate is also available.



## After Sales Support

Did you know that if you damage a panel, you don't need to replace the complete door? For your convenience and peace of mind repair panel and many replacement parts are available ex stock. Items can be bespoke ordered if required.

Maintenance and repairs are carried out by our national network of door specialists.



Wicket doors and pass doors available on request





Supplied by:



Jubilee Road, Newtownards, Co Down. BT23 4YH  
t: +44 (0)28 9181 5337 f: +44 (0)28 9182 0153 e: sales@tilt-a-dor.co.uk

[www.tilt-a-dor.co.uk](http://www.tilt-a-dor.co.uk)

Due to our continuing policy of development and improvement, we reserve the right to alter and amend the specifications shown in this literature. All dimensions are nominal. We make every effort to ensure perfect colour reproduction, but owing to printing limitations, the colours shown may not match exactly. Actual product samples should be obtained from your door supplier.